

RA65 SERIES

POLE MOUNT

Cat. #		Approvals
Job	Type	

**DEVINE
LIGHTING™**

SPECIFICATIONS

- Lens is opal for uniform downlighting; Tempered glass on HID and incandescent and polycarbonate on the PLT42 fluorescent; Gasketed to housing and supported by the cast aluminum door frame and secured with tamper-resistant stainless steel allenhead screws
- Housing is heavy-wall cast aluminum for durability; Extruded arm provides solid mounting; Specify round or square poles in catalog logic; Poles require the Devine #9 drilling pattern
- Opal lens provides a soft Type V distribution.
- Available in 70watt metal halide and HPS, 2PLC26 or PLT42 fluorescent; Lamps not included unless ordered as option
- Standard powder paint finishes include dark bronze, black, white and platinum
- Full cutoff distribution
- Listed to UL1598 for use in wet locations

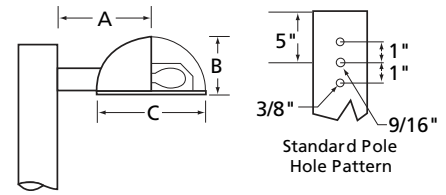

	A	B	C
RA65	12 1/4"	7 7/8"	15 1/2"
	311 mm	200 mm	394 mm



ORDERING INFORMATION

ORDERING EXAMPLE: RA65-70MH-120-DB-BOAR-LP

SERIES	WATTAGE/SOURCE ¹	VOLTAGE	FINISH	MOUNT	OPTIONS
RA65 Straight Arm	PULSE START METAL HALIDE 70MH 70w PSMH, medium base HIGH PRESSURE SODIUM 70HPS 70w HPS, medium base FLUORESCENT PLT42-ELB 42w CFL, GX24q-4 base 2PLC26 2 26w CFL, GX24D-3 base, mag.	120 120V 277 277V DV Dual Voltage 120/277V MT Multi-Tap 120/208/240/277V 347 347V	DB Dark Bronze BLK Black WHT White SAL Platinum	BOAR² Bolt-on arm (round pole) BOAS² Bolt-on arm (square pole) TE Tenon mount (3" OD slip fit)	F Fusing LP Lamp included

¹ All HID units require medium base lamps
² Uses #9 drilling pattern on Spaulding RSA4 or RSS4 poles

NOTE: EPA 0.76 Sq Ft.

Due to our continued efforts to improve our products, product specifications are subject to change without notice.

**DEVINE
LIGHTING™**

Devine Lighting • 701 Millennium Boulevard • Greenville, SC 29607 • PHONE: 864-678-1000
For more information visit our web site: www.devine-ltg.com