

# LMS 400/500/600

Cat. #		Approvals
Job	Type	

**DEVINE  
LIGHTING™**

## SPECIFICATIONS

- Rugged Devine Design cast aluminum (optional cast bronze) construction Housing designs for concrete pour and drywall installations; 3/4" wiring box hubs
- Cast aluminum (optional cast bronze) face with stainless steel allenhead tamper-resistant hardware; Clear tempered glass lens is mounted for cutoff distribution; Decorative glow from lower face presents stylish appearance
- Formed aluminum reflector provides soft, uniform spotlight distribution
- NEW! 5 watt 120Volt LED system provides long life, low maintenance
- Three sizes allow proper scale and wattage sources for various applications
- Standard finishes are dark bronze, black, white and platinum; Optional cast bronze face has brushed satin finish
- Units are designed for use in wet locations

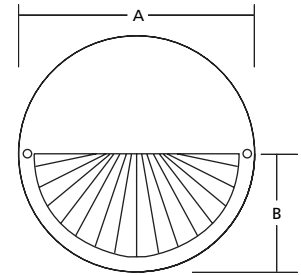
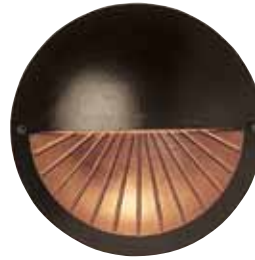

	A	B	Depth
<b>LMS 400</b>	7 1/4"	3 5/8"	4"
	184 mm	92 mm	102 mm
<b>LMS 500</b>	9 1/2"	4 3/4"	6"
	241 mm	121 mm	152 mm
<b>LMS 600</b>	13"	6 1/2"	7"
	330 mm	165 mm	178 mm

Note: Rough-in for drywall installation:  
LMS 400 = 6 1/2" dia. x 4"  
LMS 500 = 8 3/4" dia. x 6"  
LMS 600 = 10 3/4" dia. x 7"

## ORDERING INFORMATION

ORDERING EXAMPLE: LMS400-PL7-120-DB-DW

SERIES	WATTAGE/SOURCE	VOLTAGE	FINISH	OPTIONS
<b>LMS400</b> LMS 400 Series	<b>LMS 400 SERIES</b>	<b>120</b> 120V	<b>DB</b> Dark Bronze	<b>DW<sup>1</sup></b> Drywall
<b>LMS500</b> LMS 500 Series	<b>PL7</b> 7w CPL, G23 base, mag.	<b>277</b> 277V	<b>BLK</b> Black	<b>CP<sup>1</sup></b> Concrete pour
<b>LMS600</b> LMS 600 Series	<b>PLC13</b> 13w CPL, GX23-2 base, mag.	<b>MT</b> Multi-Tap 120/208/240/277V	<b>WHT</b> White	<b>BZ</b> Cast bronze face
	<b>40INC</b> 40w Incandescent, medium base	<b>347</b> 347V	<b>SAL</b> Platinum	<b>BZ1</b> All cast bronze fixture
	<b>5L<sup>2</sup></b> 5w LED			<b>F</b> Fusing
	<b>LMS 500 SERIES</b>			<b>LP</b> Lamp included
	<b>70HPS</b> 70w HPS, medium base			
	<b>70MH</b> 70w PSMH, medium base			
	<b>100INC</b> 100w Incandescent, medium base			
	<b>LMS 600 SERIES</b>			
	<b>100HPS</b> 100w HPS, medium base			
	<b>70MH</b> 70w PSMH, medium base			
	<b>100MH</b> 100w PSMH, medium base			
	<b>PLT26-ELB</b> 26w CFL, GX24q-4 base			
	<b>2PLT26-ELB</b> 2 26w CFL, GX24q-4 base			
	<b>200INC</b> 200w Incandescent, medium base			

1 Must select drywall or concrete pour  
2 120V only, 73 lumens, 6530K CCT

Due to our continued efforts to improve our products, product specifications are subject to change without notice.

**DEVINE  
LIGHTING™**

Devine Lighting • 701 Millennium Boulevard • Greenville, SC 29607 • PHONE: 864-678-1000

For more information visit our web site: [www.dual-lite.com](http://www.dual-lite.com)